

- CANALIZACION DE 4 TUBOS Ø 200 PE CORRUGADO
  - ▣ ARQUETA TIPO A-1
  - ARQUETA TIPO A-2
  - ||||| LIMITE DEL PRIMER DESGLOSADO
- SE INTERCALARAN EN LA CANALIZACION ARQUETAS CADA 50 METROS

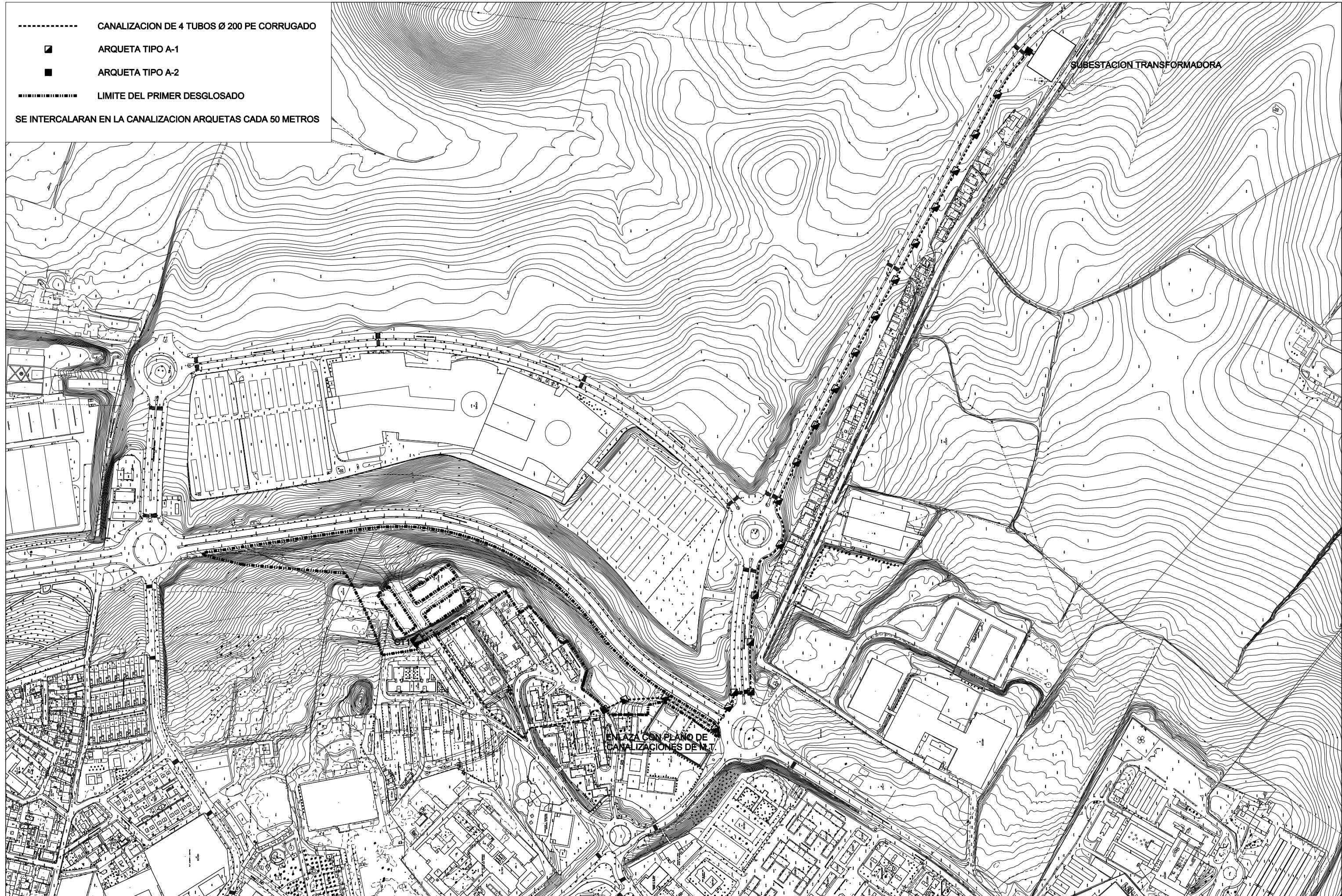









----- CIRCUITOS 3(1x240)mm AL 18/30 KV  
 ■■■■■■■■■■ LIMITE DEL PRIMER DESGLOSADO

SUBESTACION TRANSFORMADORA



**CANALIZACIONES DE MEDIA TENSION**



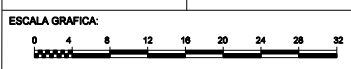
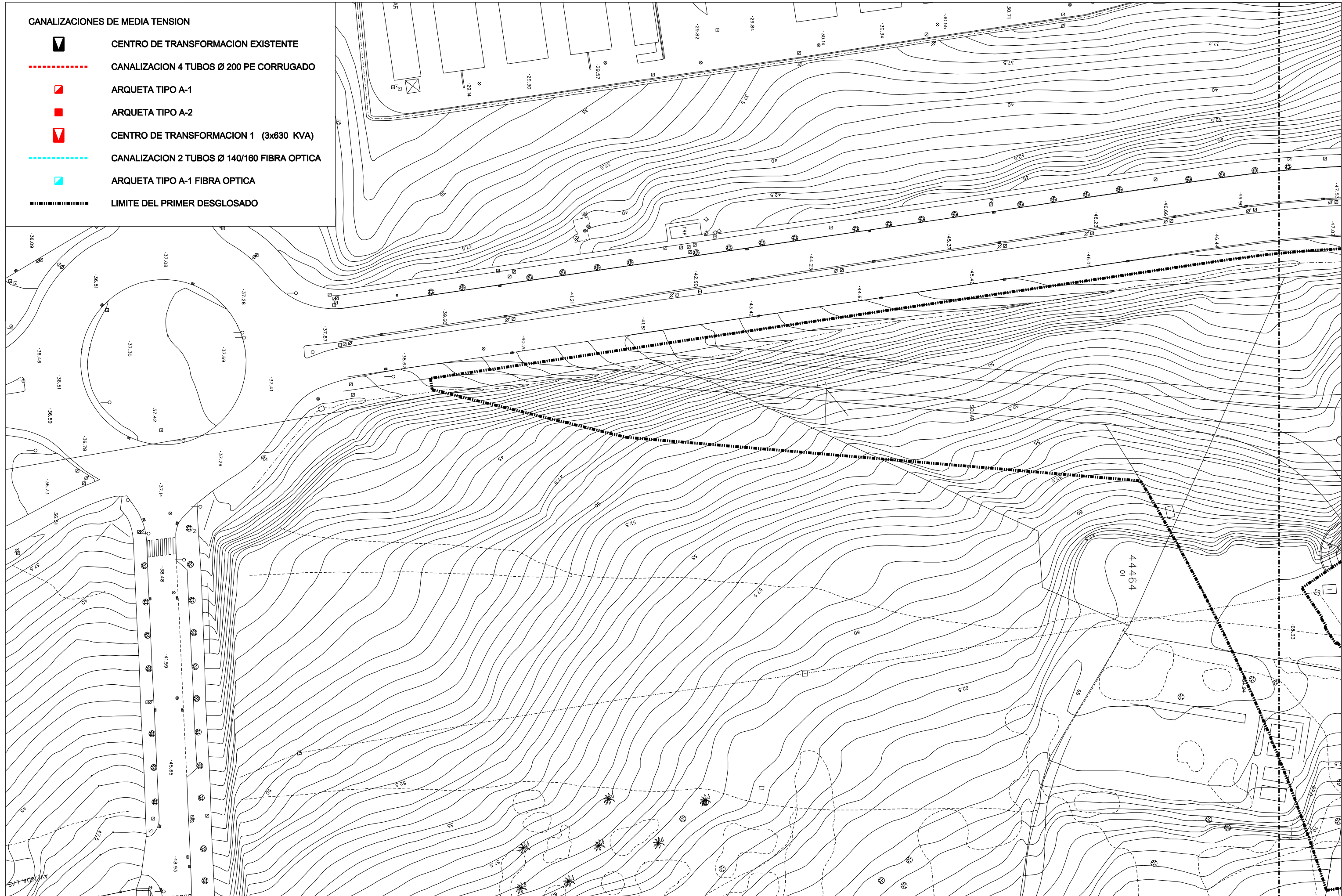

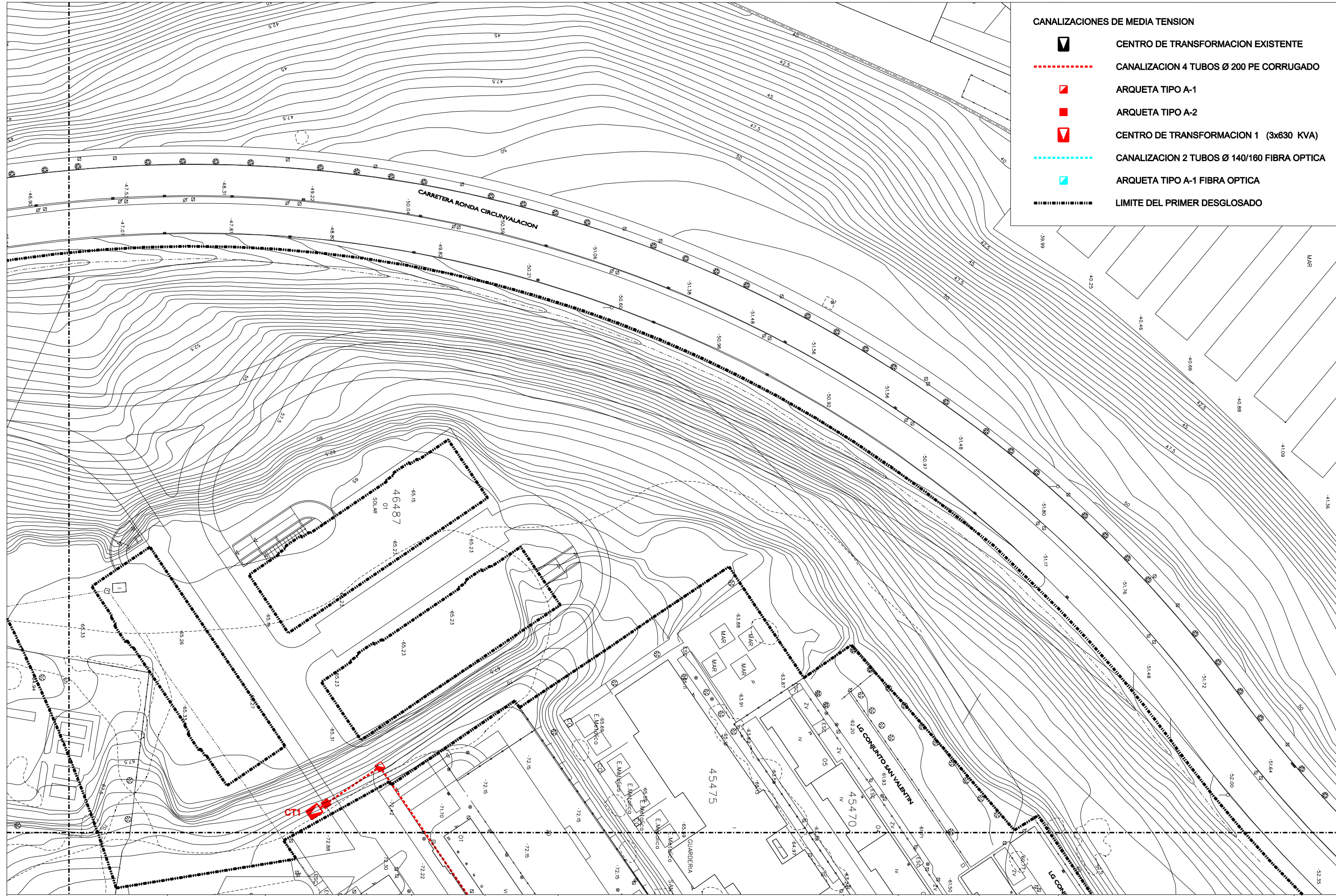
-  **CENTRO DE TRANSFORMACION EXISTENTE**
-  **CANALIZACION 4 TUBOS Ø 200 PE CORRUGADO**
-  **ARQUETA TIPO A-1**
-  **ARQUETA TIPO A-2**
-  **CENTRO DE TRANSFORMACION 1 (3x630 KVA)**
-  **CANALIZACION 2 TUBOS Ø 140/160 FIBRA OPTICA**
-  **ARQUETA TIPO A-1 FIBRA OPTICA**
-  **LIMITE DEL PRIMER DESGLOSADO**



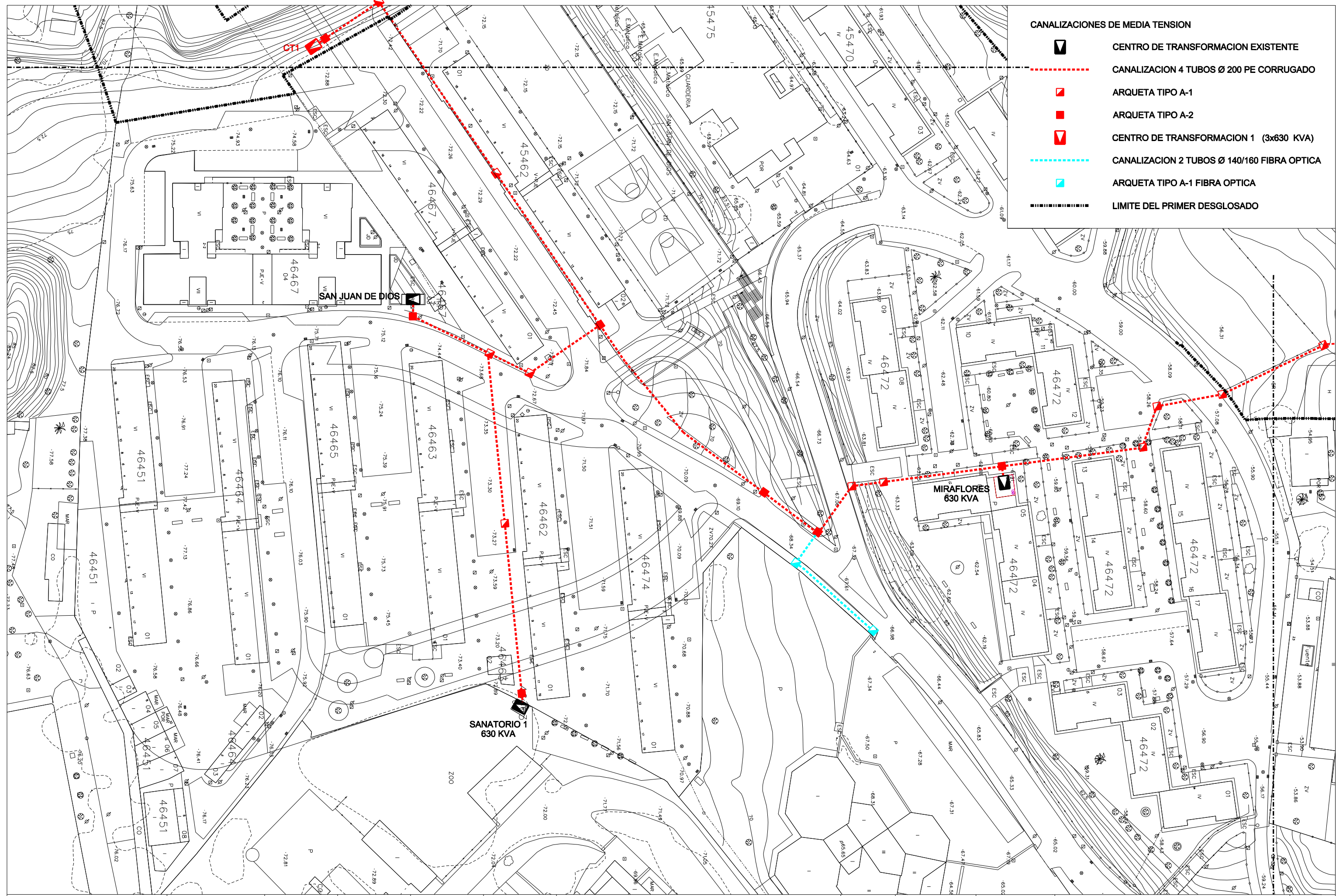







CANALIZACIONES DE MEDIA TENSION	
	CENTRO DE TRANSFORMACION EXISTENTE
	CANALIZACION 4 TUBOS Ø 200 PE CORRUGADO
	ARQUETA TIPO A-1
	ARQUETA TIPO A-2
	CENTRO DE TRANSFORMACION 1 (3x630 KVA)
	CANALIZACION 2 TUBOS Ø 140/160 FIBRA OPTICA
	ARQUETA TIPO A-1 FIBRA OPTICA
	LIMITE DEL PRIMER DESGLOSADO



- CANALIZACIONES DE MEDIA TENSION**
-  CENTRO DE TRANSFORMACION EXISTENTE
  -  CANALIZACION 4 TUBOS Ø 200 PE CORRUGADO
  -  ARQUETA TIPO A-1
  -  ARQUETA TIPO A-2
  -  CENTRO DE TRANSFORMACION 1 (3x630 KVA)
  -  CANALIZACION 2 TUBOS Ø 140/160 FIBRA OPTICA
  -  ARQUETA TIPO A-1 FIBRA OPTICA
  -  LIMITE DEL PRIMER DESGLOSADO







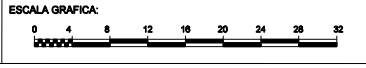
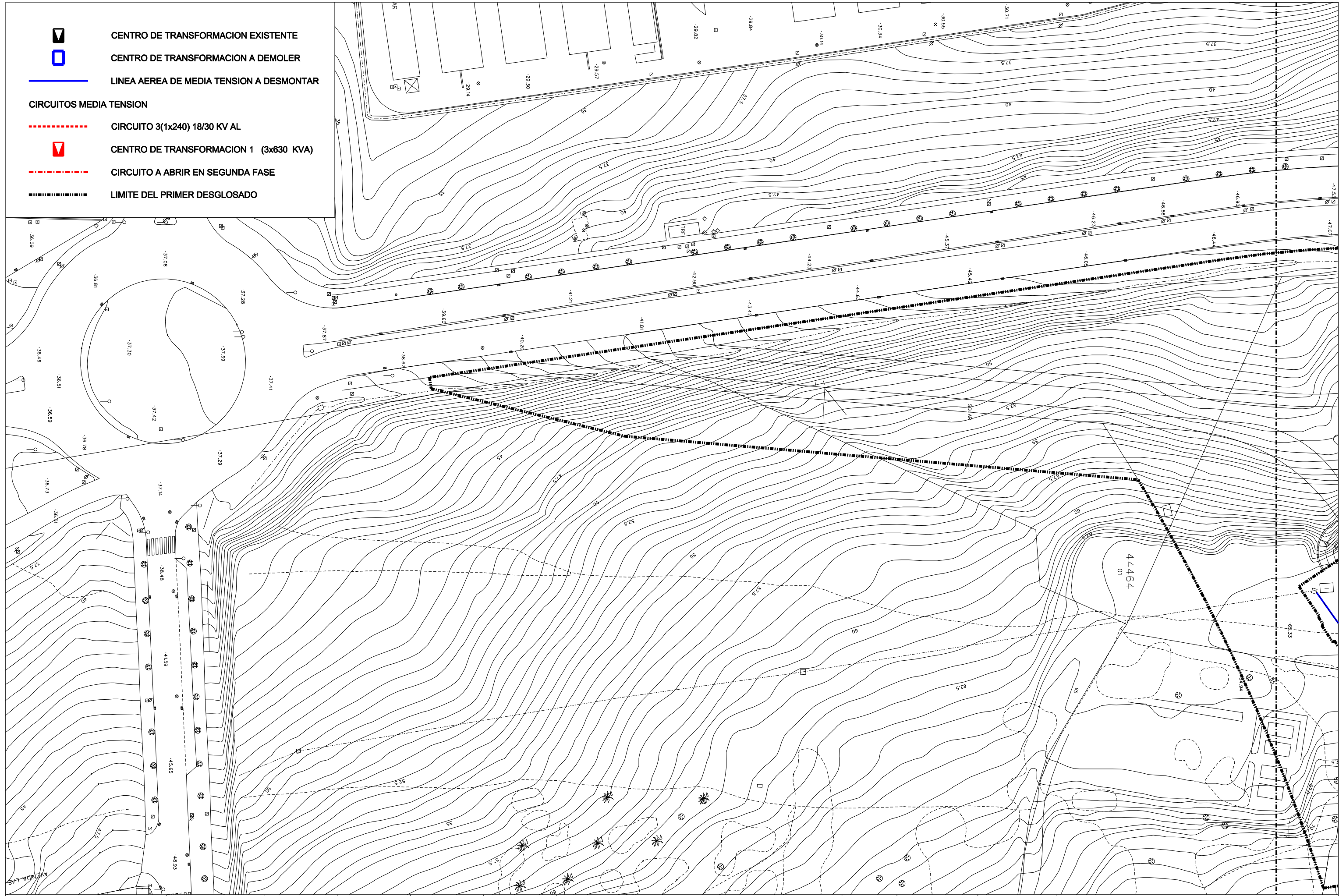

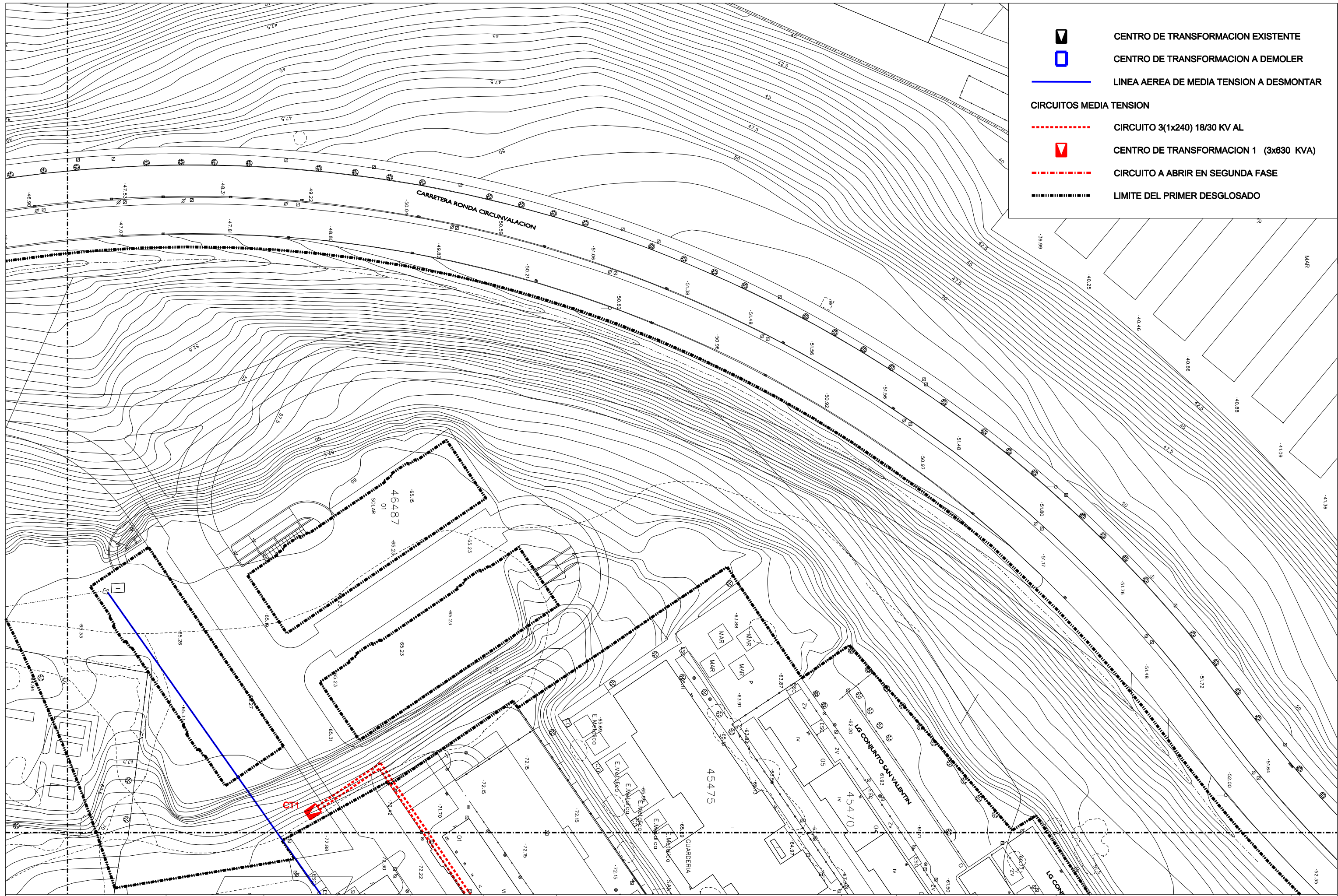

-  CENTRO DE TRANSFORMACION EXISTENTE
-  CENTRO DE TRANSFORMACION A DEMOLER
-  LINEA AEREA DE MEDIA TENSION A DESMONTAR
- CIRCUITOS MEDIA TENSION**
-  CIRCUITO 3(1x240) 18/30 KV AL
-  CENTRO DE TRANSFORMACION 1 (3x630 KVA)
-  CIRCUITO A ABRIR EN SEGUNDA FASE
-  LIMITE DEL PRIMER DESGLOSADO





-  CENTRO DE TRANSFORMACION EXISTENTE
-  CENTRO DE TRANSFORMACION A DEMOLER
-  LINEA AEREA DE MEDIA TENSION A DESMONTAR
- CIRCUITOS MEDIA TENSION**
-  CIRCUITO 3(1x240) 18/30 KV AL
-  CENTRO DE TRANSFORMACION 1 (3x630 KVA)
-  CIRCUITO A ABRIR EN SEGUNDA FASE
-  LIMITE DEL PRIMER DESGLOSADO



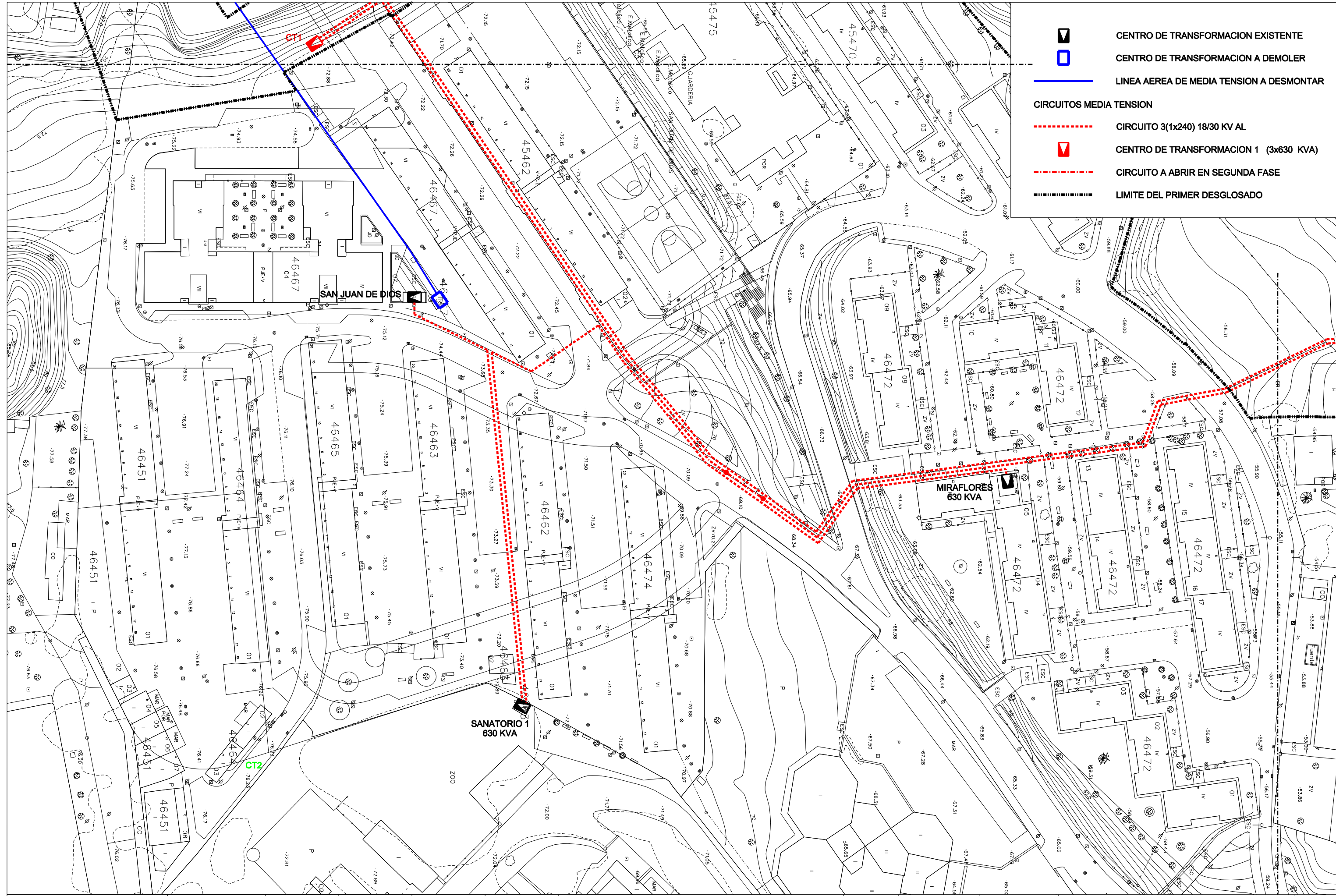

- CENTRO DE TRANSFORMACION EXISTENTE
- CENTRO DE TRANSFORMACION A DEMOLER
- LINEA AEREA DE MEDIA TENSION A DESMONTAR
- CIRCUITOS MEDIA TENSION**
- CIRCUITO 3(1x240) 18/30 KV AL
- CENTRO DE TRANSFORMACION 1 (3x630 KVA)
- CIRCUITO A ABRIR EN SEGUNDA FASE
- LIMITE DEL PRIMER DESGLOSADO

